

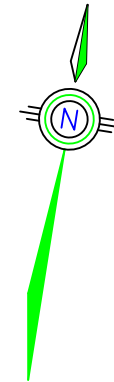

Ainley Graham and Associates Limited.  
Consulting Engineers and Planners

Collingwood - Barrie - Belleville - Ottawa

SCALE: 1:9000	PLOT: 1=9	JOB NO. 97550-1
DESIGN: B.B.	CHECKED: B.B.	DWC. 97550-1
DRAWN: K.S.	DATE: JANUARY 2000	

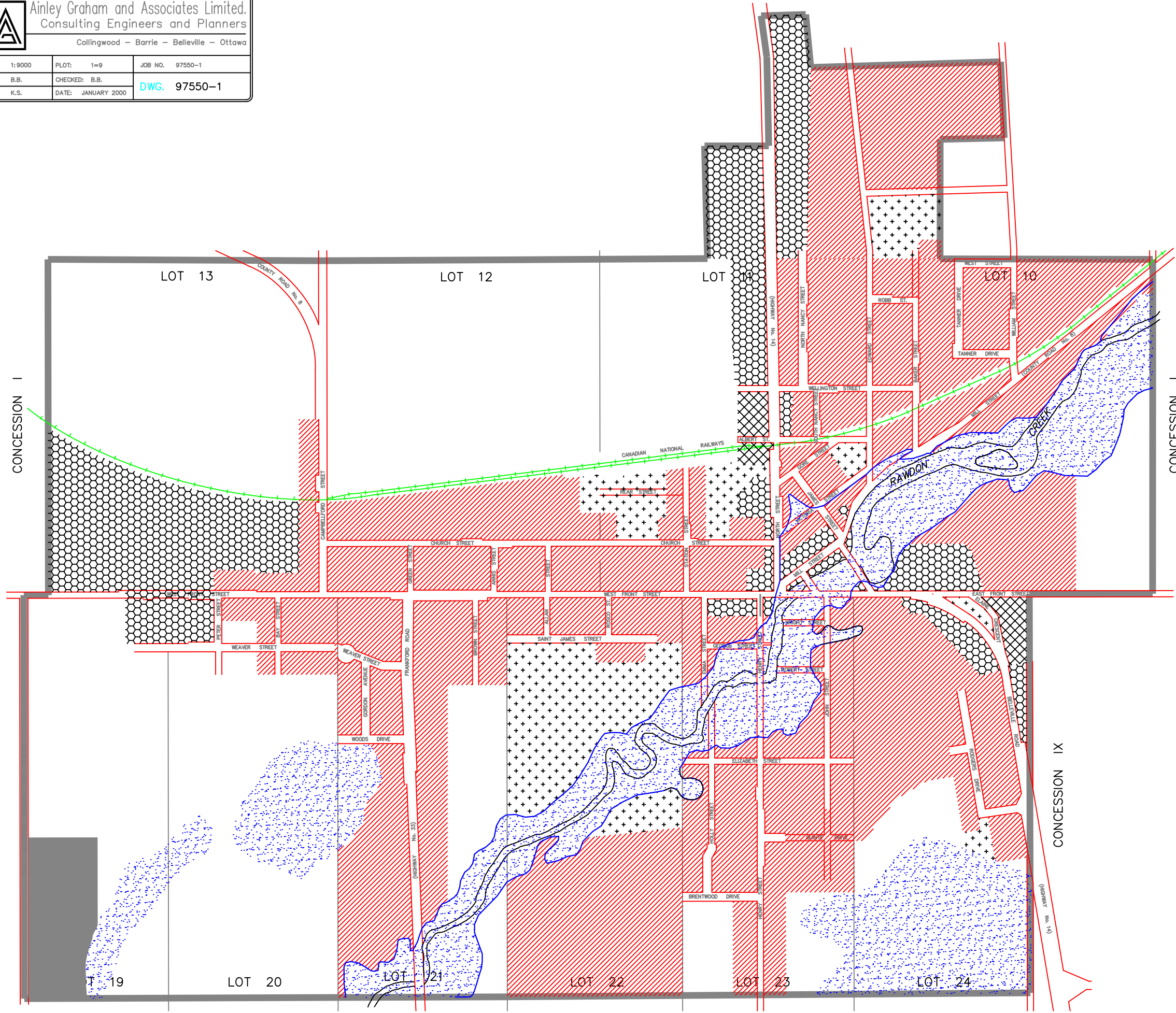

**LEGEND**

- RESIDENTIAL
- COMMERCIAL
- INDUSTRIAL
- SOLID WASTE DISPOSAL
- COMMUNITY FACILITY
- ENVIRONMENTAL PROTECTION
- DEVELOPMENT
- APPROXIMATE FLOODLINE
- URBAN AREA BOUNDARY

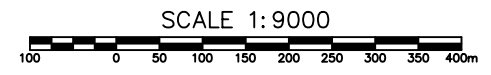

**STIRLING URBAN AREA**  
 OFFICIAL PLAN OF THE COUNTY OF HASTINGS  
 APPENDIX 'E-1' - LAND USE PLAN