

- LEGEND**
- AGRICULTURAL
 - ENVIRONMENTAL PROTECTION
 - ENVIRONMENTALLY SENSITIVE
 - SIGNIFICANT WETLANDS
 - RURAL
 - HAMLET
 - URBAN
 - EXTRACTIVE
 - EXTRACTIVE (RESERVE)
 - WASTE DISPOSAL SITES
 - COLD WATER FISHERIES (STREAMS AND LAKES)
 - FLOODLINE
 - PROVINCIAL HIGHWAYS
 - MUNICIPAL ROADS
 - PRIVATE ROADS
 - UNOPENED ROAD ALLOWANCES
 - PRECAMBRIAN

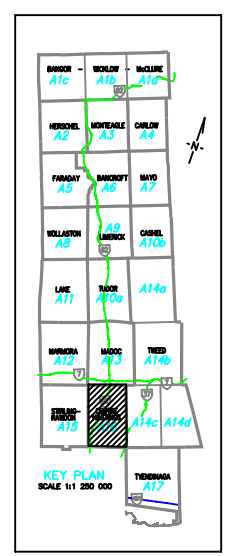
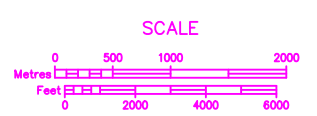

TOWNSHIP OF CENTRE-HASTINGS

OFFICIAL PLAN OF THE COUNTY OF HASTINGS
SCHEDULE 'A16' (MODIFIED)